

SafeMask Architect Pro™

MASK DONNING



A Fit Test should always be performed before donning a mask.

Always clean your hands before applying the mask.

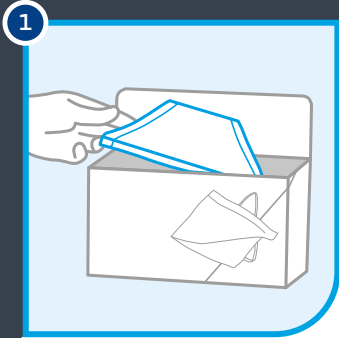

1 REMOVE MASK FROM PACKAGING

Remove mask from outer box.

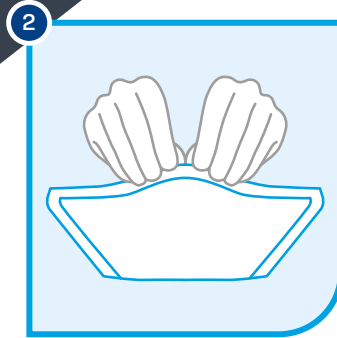

2 ARCH NOSE PIECE

Prepare by shaping the nose piece.

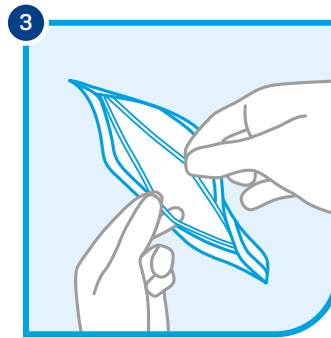

3 SEPARATE COMFORT BANDS

Hold the centre of the comfort bands and pull apart to separate.

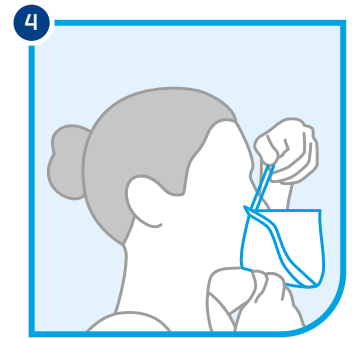

4 PUT THE MASK ON

Place the bottom of the mask under your chin.

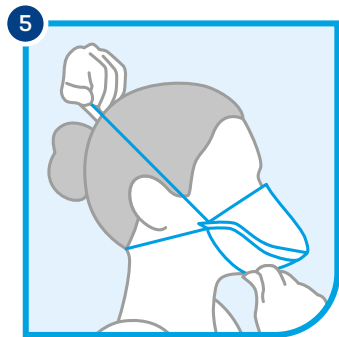

5 PUT ON THE COMFORT BANDS

Support the mask below your chin with one hand. With the other hand, pull comfort bands over your head.

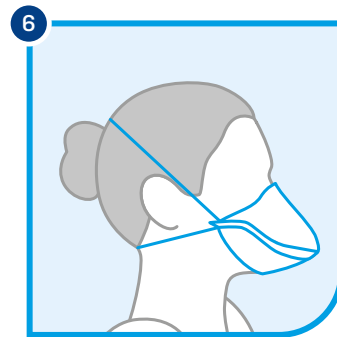

6 POSITION THE COMFORT BANDS

Place the top band around the crown of your head and position the second band so that it fits securely and comfortably.

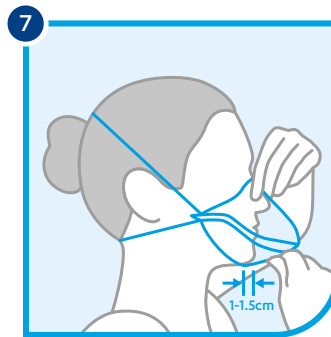

7 POSITION THE MASK CORRECTLY

Make sure the mask sits comfortably below your chin, about 1–1.5 cm behind the jawbone, and across the bridge of your nose.

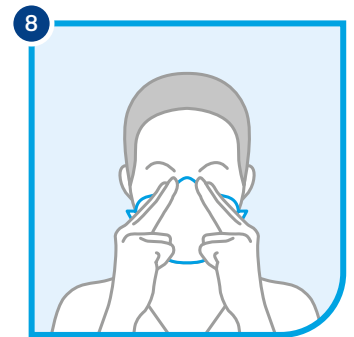

8 SEAL THE MASK

With two fingers on either side of your nose, firmly shape around your nose and across your cheeks, concentrating on the bridge of your nose, to secure the seal.

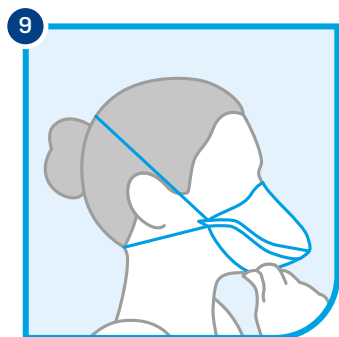

9 CHECK FIT

No air should leak from the edges of the mask. If in doubt, repeat step 8, pressing firmly.



10 SELF TEST

MAKE SURE THE MASK ADHERES TIGHTLY TO YOUR FACE

- Cup your hands over entire front of mask to block airflow.
- Inhale deeply.
- If any air flows around your nose, repeat step 8.
- If any air flows around the mask, carefully adjust the bands and repeat step 8.
- If fit is not satisfactory, do not enter an area where a mask is required.

SafeMask Architect Pro™ MASK DOFFING

It is important not to touch the fabric of the mask during removal or disposal.

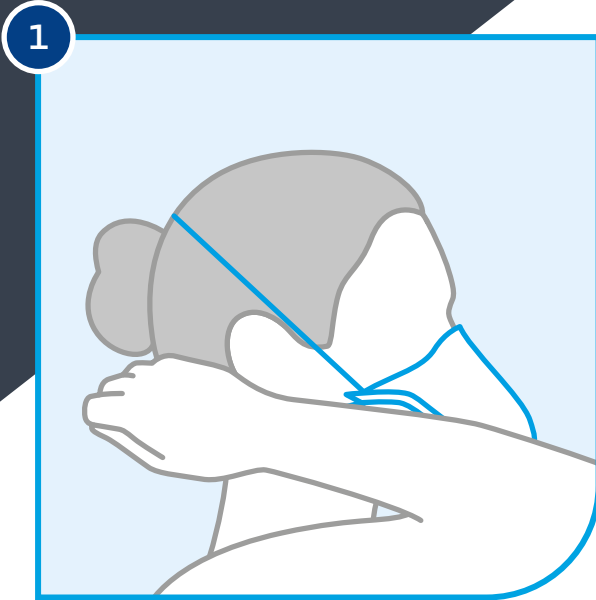

Hold the bands at the back of your head.

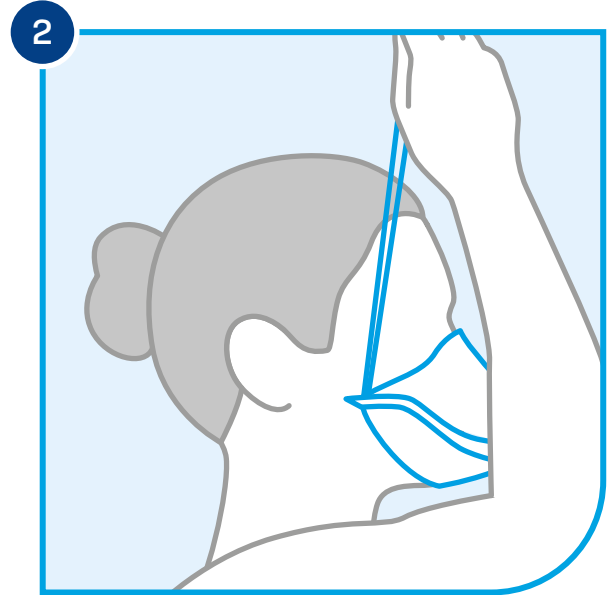

Pull the bands over your head and remove the mask by pulling it away from your face, taking care not to touch its outer surface.

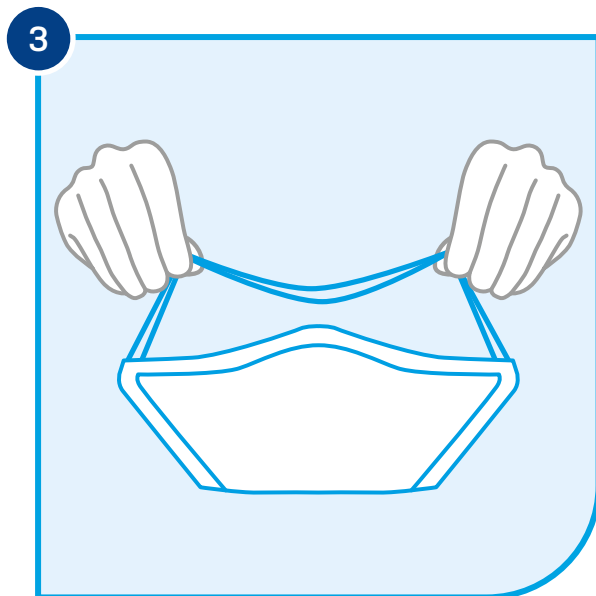

Still holding the bands, dispose of the mask in the clinical waste bin provided. Do not touch the fabric of the mask.



Always wash your hands thoroughly after removing a mask.