





## KOLMI TRAINING SESSION AGENDA

- KOLMI / MEDICOM OVERVIEW – WHO WE ARE
- THE KOLMI FFP3 MASK – WHAT MAKES IT DIFFERENT
- DONNING & DOFFING - OUR FFP3 MASKS
- FIT TESTING - HINTS AND TIPS
- OUR MASK RANGE
- THE KOLMI SUPPORT PACKAGE
- ANY QUESTIONS

PLEASE FEEL FREE TO ASK QUESTIONS AS WE RUN THROUGH



## MEDICOM OVERVIEW

Last year we made over three billion face masks

**2020**

Kolmi opens a UK factory and becomes one of the key suppliers of single-use masks to the NHS.

---

**2012**

Kolmi celebrates its 40th anniversary. Over two billion single-use masks have been produced since launch.

---

**2011**

Medicom acquires the majority shareholding in Kolmi-Hopen.

---

**2007**

Kolmi becomes the leading supplier of surgical masks for the operating theatre in France.

---

**1975**

Kolmi creates its first non-woven single-use mask.

---

**1972**

Kolmi manufactures Europe's first single-use paper mask.

---

**1921**

Factory is established in Angers specialising in cigarette paper manufacturing.

Kolmi are part of the Medicom Group - one of the worlds leading manufacturer of single use preventative and infection control products.

Kolmi have been manufacturing masks in Europe for over 45 years

We have 9 dedicated factories and sell in over 95 countries

We are the number one supplier of masks to the French health industry.

We have developed products and built a state of the art factory here in the UK to service the NHS



## THE FFP3 MASK



<https://www.youtube.com/watch?v=-EOcrxKyO7k>





# FFP3 MASK DONNING & DOFFING

Detailed animations are available  
simple click on the links below

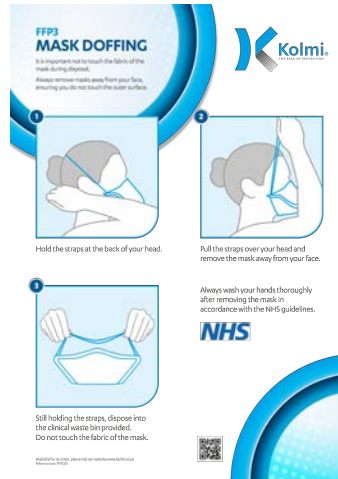
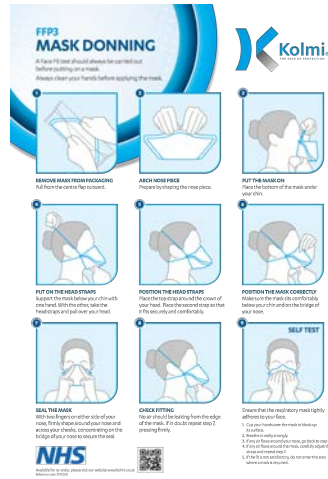

<https://www.youtube.com/watch?v=qKQUrlBgRdl>

[https://www.youtube.com/watch?v=QdiiSc4\\_f4c](https://www.youtube.com/watch?v=QdiiSc4_f4c)



## FIT TESTERS HINTS AND TIPS

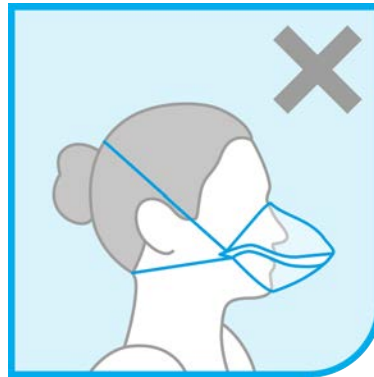
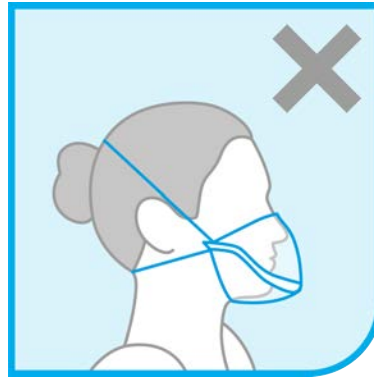
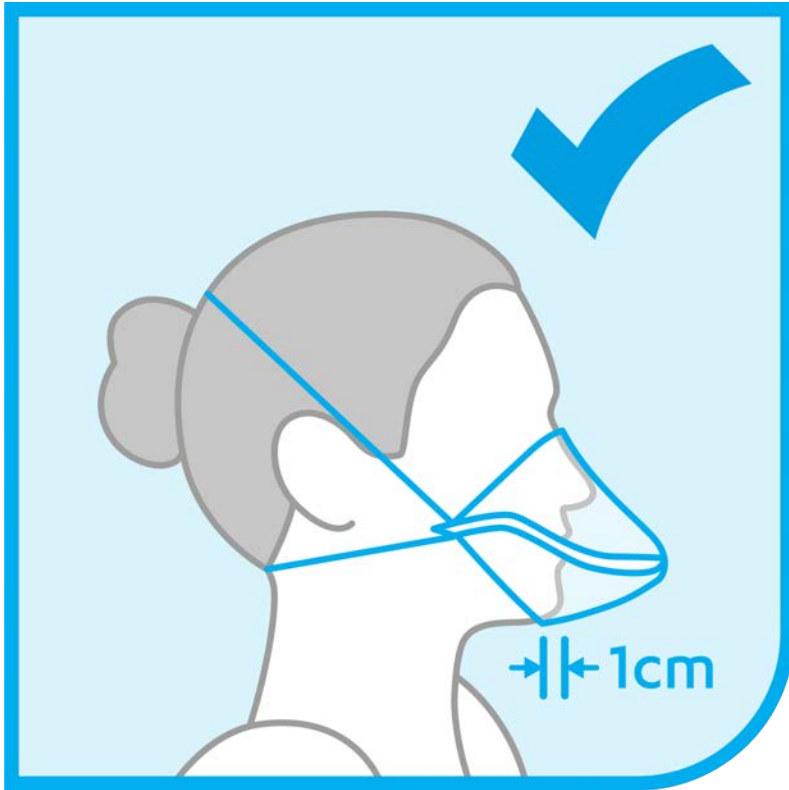

Alongside with the usual conditions eg - remove glasses, clean shaven etc we have found with the Kolmi masks that the following actions ensure great fit test success.

- Gently curve the nose piece before starting donning
- Ensure the mask is located just under the chin about 1 - 1.5cm behind the jaw bone
- Make sure it does not go all the way back to the throat
- Ensure there is plenty of space to the front of the mask
- Ensure the top strap sits high on the head - towards the crown - and the bottom under the ears where possible
- The key area is the nose bar ensure the wearer does not pinch the bar into a 'V'
- Use 2 fingers either side of the nose and mould it firmly to the shape of the nose and the nose and the cheek bones
- This mask has been designed for one single continuous work session, i.e for 8 hours as a maximum (ensure to follow the Infection Control Team guidelines)
- The current pass rate in test in Canada is in excess of 80% on the medium mask.

The key with the Kolmi mask is that it is very lightweight and comfortable to wear for long periods it is essential that there is plenty of space to the front of the mask to hold it away from the mouth.

## OUR MASK RANGE

CODE	SIZE	AVAILABLE
M53010S-WH M53014S-WH M53014S-WH-UK	Medium	NOW
M53214S-WH-UK	Small	Early March 2021
M53114S-WH-UK	Large	Early March 2021

M53010S-WH / M53214S-WH-UK / M53114S-WH-UK are verified as equivalent from a fit test perspective

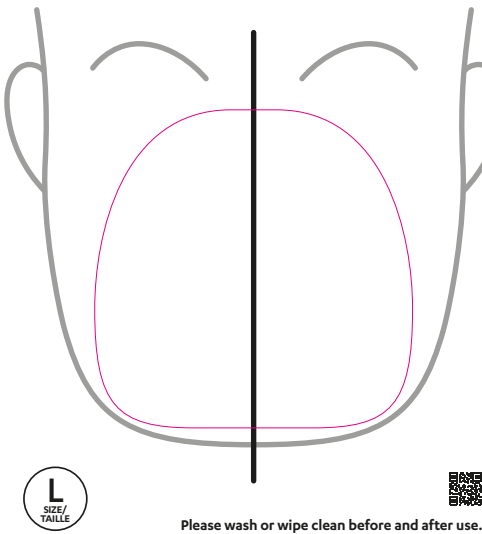
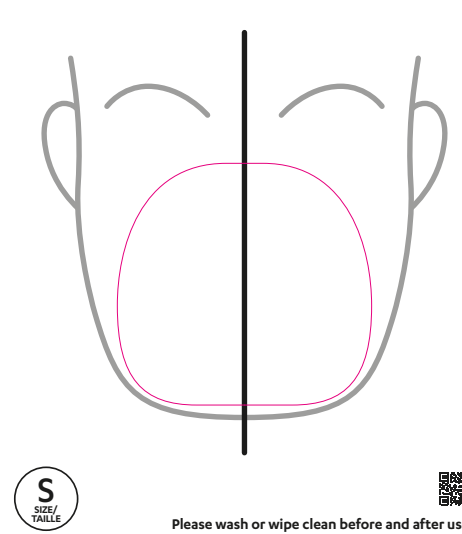

- Sizing guides available
- Help identify which mask will fit
- Help the fit test process get completed quickly and easily.
- Size of mask is dependent on face shapes and ethnicity
- Medium covers approx. 70% of all test undertaken

## THE KOLMI SUPPORT PACKAGE - WHAT IS IN YOUR PACK?



**Donning & Doffing Posters**  
6 x posters A4 2pp



**End User Guide**  
10 x A5 6pp



**Evaluation Cards**  
30 x end user cards



**Pen**  
1 x permanent marker





## THE KOLMI SUPPORT PACKAGE – OUR WEBSITE

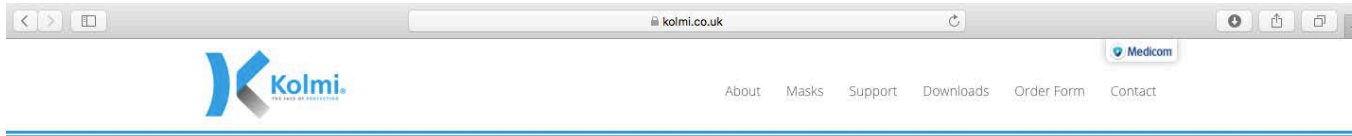

### WELCOME TO KOLMI

The Kolmi® masks are manufactured by the Medicom® Group - one of the world's leading manufacturers of high-quality single-use preventative and infection control products for the medical industry.

We have over 45 years' experience in mask manufacture and have nine fully owned sites, including one here in the UK, and we sell in over 95 countries. Our UK range of Kolmi masks have been developed with the requirements of the NHS at the centre of what we do.



### OP-R TYPE II R MASKS



### OP-Air PRO™ FFP3 MASKS



### Fit testing Support

All support materials are available online

All pdf's and videos can be downloaded

Use our order form to order more literature as needed

<https://kolmi.co.uk>





## ANY QUESTIONS?

Please email the following address, if you have any follow up questions:

[ffp3-uk@medicom.com](mailto:ffp3-uk@medicom.com)